

# DEERFIELD TOWNSHIP SECTION 33 & 34 R13 TWP 9 MORGAN COUNTY, OH

## BRUNER-JOHNSON SUBD No. 4

PIN	VOL	PAGE	Owner	LegalDescr	Acres
040-002-220-1	OR168	421	CROSSROADS CHRISTIAN FELLOWSHIP	BRUNER-JOHNSON S	4
040-002-220-7	OR168	421	CROSSROADS CHRISTIAN FELLOWSHIP	BRUNER-JOHNSON S	5.033
040-002-220-5	OR233	2871	DAVIS BARRY E & NANCY E	BRUNER-JOHNSON S	5.792
040-002-220-4	OR233	2871	DAVIS BARRY E & NANCY E	BRUNER-JOHNSON S	5.008
040-002-220-2	OR35	106	GIBSON SHIRLEY A	BRUNER-JOHNSON S	5
040-002-221-3	OR181	213	JORDAN HEATHER & DANIEL R RINEHART	INLOT 19-A BRUNER J	1.097
040-002-220-3	OR181	213	JORDAN RONALD & MANUELA	IN LOT 19 BRUNER-JO	3.903
040-002-180-5	OR227	1700	LEMON CHRISTOPHER L & JENNIFER E & CODY W	BRUNER-JOHNSON S	6.009
040-002-180-2	OR218	1083	MALBOUEF TIMOTHY D	BRUNER-JOHNSON S	6.034
040-002-180-3	OR216	1892	MALBOUEF TIMOTHY DUANE	R0 TO S34 BRUNER-J	6.005
040-002-220-6	OR63	335	MCCLAREN KENNETH D & JENNIFER L	BRUNER-JOHNSON S.	10.097
040-002-270-1	OR98	366	MCCLAREN KENNETH D & JENNIFER L	BRUNER-JOHNSON S	25.004
040-002-210-1	OR132	671	MOLLAHAN CHARLES A & NIKKI LYNN	R0 TO S33 BRUNER-J	10.004
040-002-270-3	OR218	616	MOORE JANITH SUE LC-KENNETH D & JENNIFER L	BRUNER-JOHNSON S	25.435
040-002-270-2	OR218	616	MOORE JANITH SUE LC-KENNETH D & JENNIFER L	BRUNER-JOHNSON S	25.022
040-002-190-3	OR211	1147	PARKER RUTH A TOD-ROBERT ALAN SKAGGS &	BRUNER-JOHNSON S	6
040-002-180-4	OR172	139	SNODGRASS DAVID & MARSHA	BRUNER-JOHNSON S	6.014
040-002-180-1	OR31	789	STEBELTON RICHARD L	BRUNER-JOHNSON S	6.013
040-002-190-2	OR50	198	WARD GEORGE & JOANN PATTERSON	BRUNER-JOHNSON S	6.007
040-002-190-1	OR50	198	WARD GEORGE & JOANN PATTERSON	BRUNER-JOHNSON S	13.002
040-002-210-2	OR2	709	WARD GEORGE & JOANN PATTERSON	BRUNER-JOHNSON S	10.231
040-002-210-3	OR2	709	WARD GEORGE & JOANN PATTERSON	BRUNER-JOHNSON S	25.032

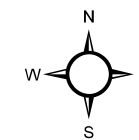
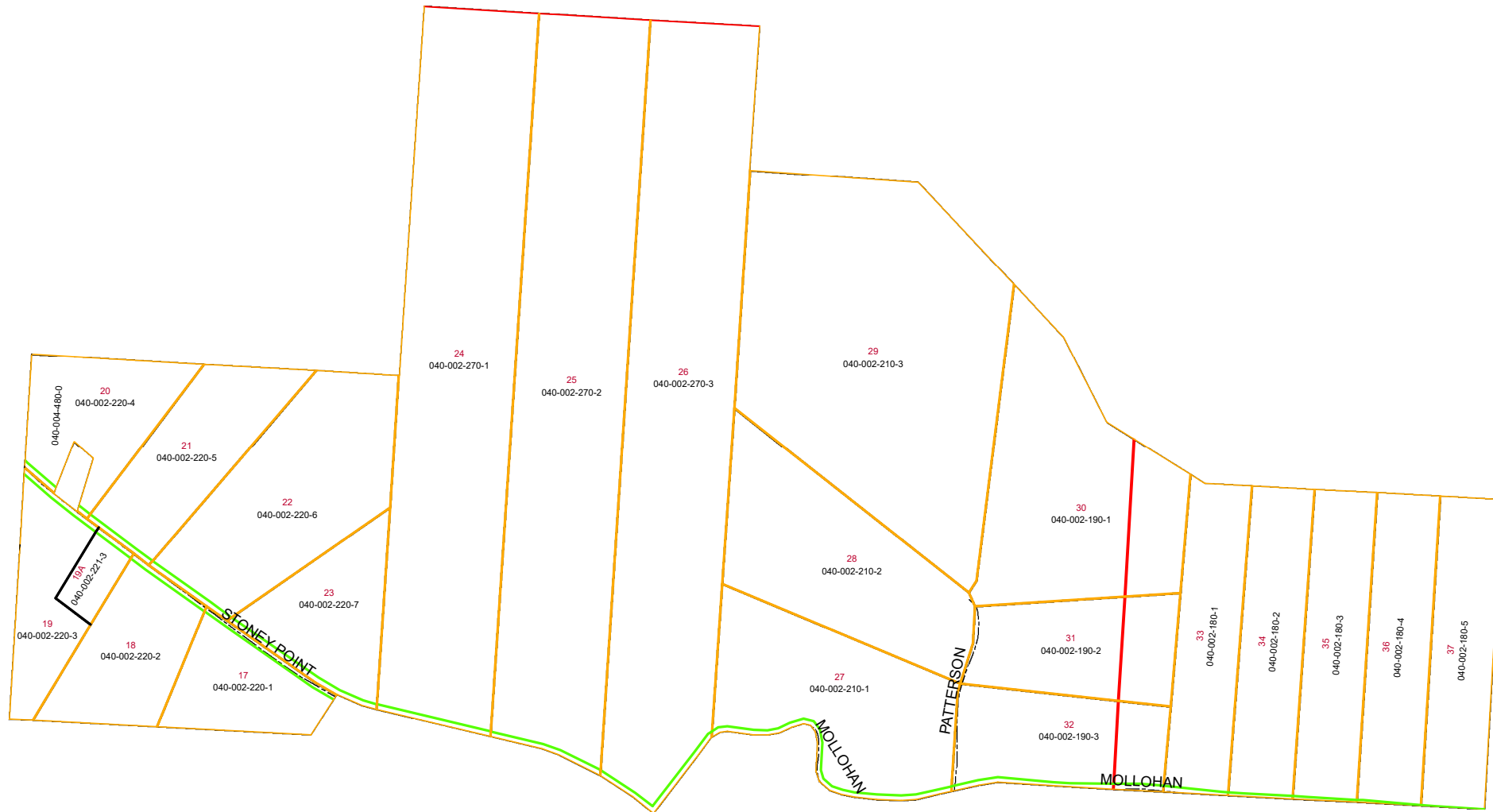

Boundaries		Type	
	Future Split		Parcel
	Hydro		ROW
	Lot		Section
	County		Township
	Roads		Roads

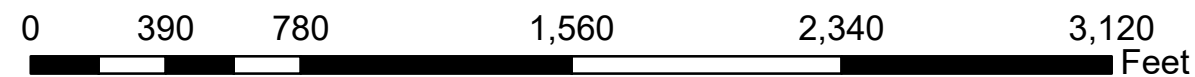

Disclaimer: The information that these maps contains is for reference purposes only. Please bring any errors to the attention of the Engineer's Office staff.

Thank you